

429 HP (318 KW) PITTSBURGH GEAR KD285FF USED GEAR REDUCER / SPEED REDUCER / GEARBOX

MANUFACTURER: PITTSBURGH GEAR

AGE: 1999

MODEL NO.: KD285FF

SERIAL NO.: 92995

HP RATING: 429

(318 KW)

INPUT RPM: 1750

RATIO: 10.4118:1

REDUCTION: DOUBLE

SERVICE FACTOR: 2.45

TYPE: PARALLEL

GEAR TYPE: HELICAL

BEARING TYPE: ROLLER

WEIGHT: 9,585 LBS.

(4,350 KG)

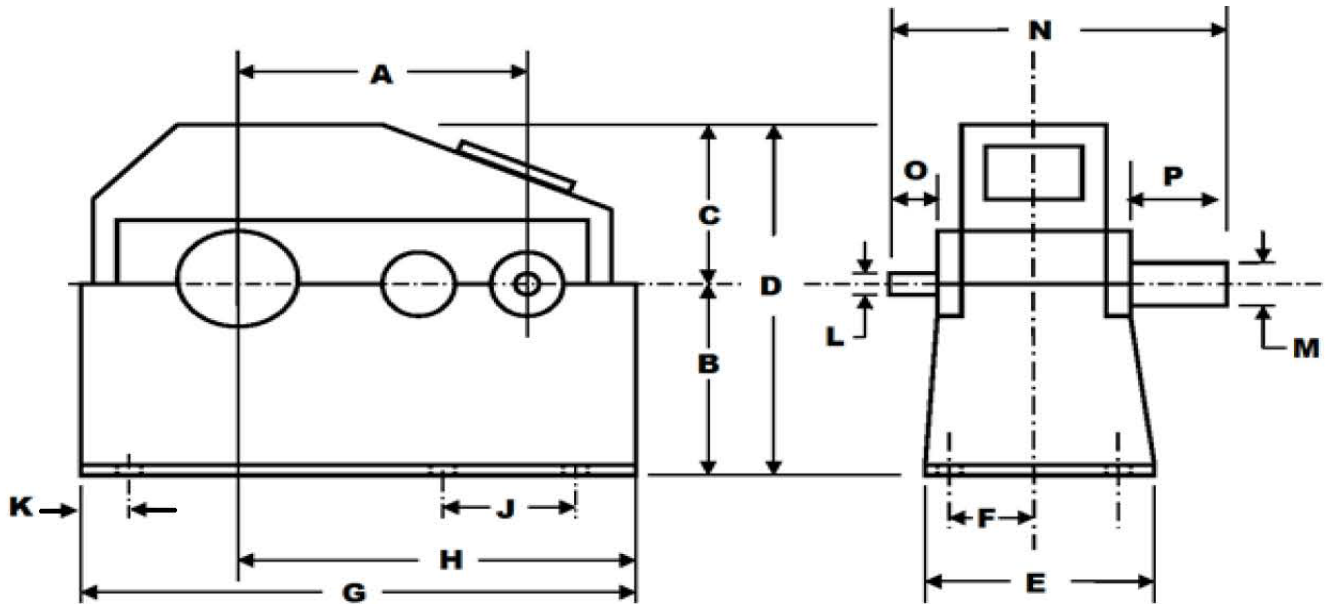

A=20"

E=22.5"

J=14.5"

N=38"

B=14"

F=7.5"

K=2.75"

O=5"

C=9"

G=42"

L=2.75"

P=12"

D=23"

H=28"

M=6"

INVENTORY ID: 200304-003-00

CASEYUSA®

Revised 3/11/19

Page 1 of 1

CASEY

275 Kappa Drive, Pittsburgh, PA 15238

Ph: (800) 882-7000 • (412) 963-1111

Fax: (412) 963-0378

E-mail: mechanicalsales@caseyusa.com

Web: www.caseyusa.com