

# 101 HP (75 KW) HORSBURGH & SCOTT MARK II RIGHT ANGLE USED GEAR REDUCER / SPEED REDUCER / GEARBOX

MANUFACTURER: HORSBURGH & SCOTT

MODEL NO.: 140-DB

SERIAL NO.: P 5408-B

HP RATING: 101

(75 KW)

INPUT RPM: 624

RATIO: 13.0:1

REDUCTION: DOUBLE

SERVICE FACTOR: 1.0

TYPE: RIGHTANGLE

GEAR TYPE: HELICAL

BEARING TYPE: ROLLER

WEIGHT: 4,000 LBS.

(1,814 KG)

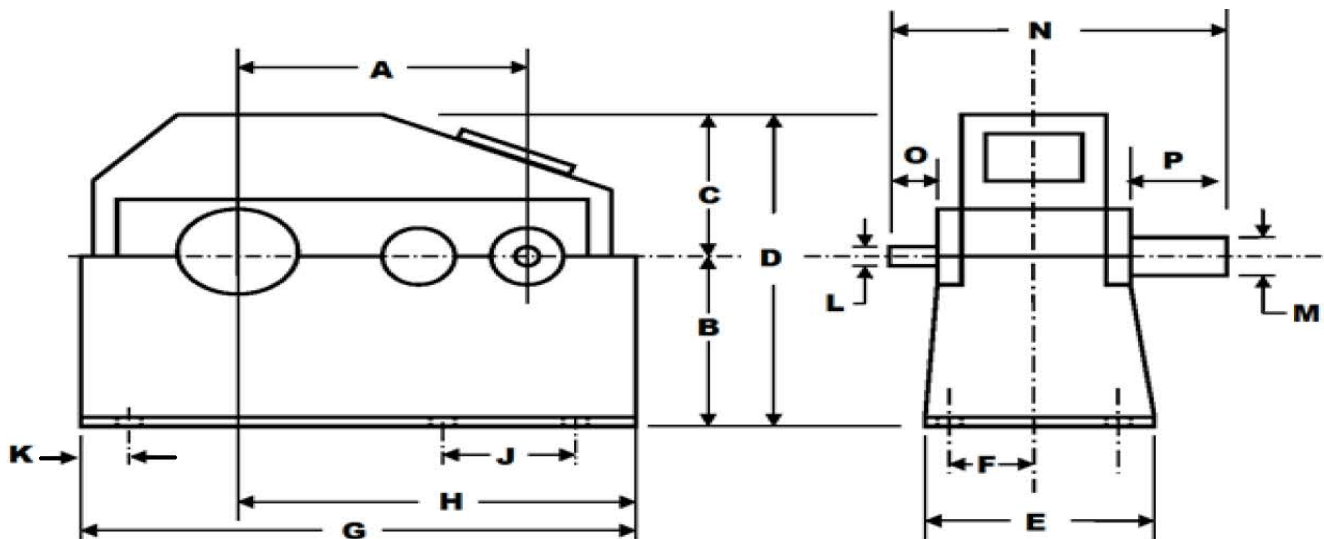

A=38"

E=12.5"

J=34"

N=22"

B=18"

F=28"

K=13"

O=7.5"

C=14"

G=42"

L=19"

P=6"

D=42"

H=17.5"

M=4.75"

INVENTORY ID: 107634-000-00

NOTE: REFERENCE TAG 107634-001-00 FOR OPPOSITE HAND

**CASEYUSA®**

Revised 2/26/19

Page 1 of 1

**CASEY**

275 Kappa Drive, Pittsburgh, PA 15238

Ph: (800) 882-7000 • (412) 963-1111

Fax: (412) 963-0378

E-mail: [mechanicalsales@caseyusa.com](mailto:mechanicalsales@caseyusa.com)

Web: [www.caseyusa.com](http://www.caseyusa.com)