

11 HP (8 KW) HORSBURGH & SCOTT LT-3200 PARALLEL USED GEAR REDUCER / SPEED REDUCER / GEARBOX

MANUFACTURER: HORSBURGH & SCOTT
 MODEL NO.: LT-3200
 SERIAL NO.: K-4443
 HP RATING: 11
 INPUT RPM: 1200
 RATIO: 354.1:1
 REDUCTION: TRIPLE
 SERVICE FACTOR: 1.0
 TYPE: PARALLEL
 GEAR TYPE: HELICAL
 BEARING TYPE: ROLLER
 WEIGHT: 6000 LBS.

(8 KW)

(2722 KG)

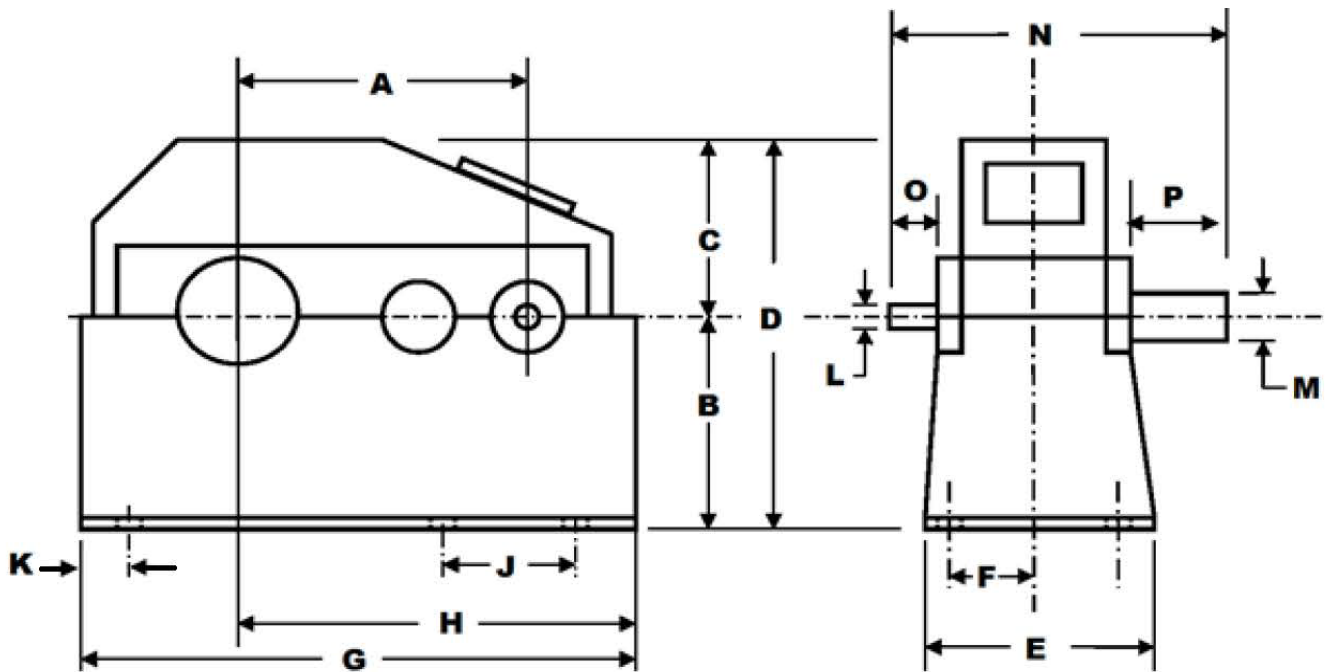

A=30.5"	E=22.5"	J=48"	N=37.75"
B=18.87"	F=9.5"	K=3"	O=7"
C=17"	G=35"	L=1.38"	P=9"
D=35"	H=50"	M=5.5"	

INVENTORY ID: 107223-000-00

CASEYUSA®

Revised 2/26/19

Page 1 of 1

CASEY

275 Kappa Drive, Pittsburgh, PA 15238

Ph: (800) 882-7000 • (412) 963-1111

Fax: (412) 963-0378

E-mail: mechanicalsales@caseyusa.com

Web: www.caseyusa.com