

18.9 HP (14 KW) HORSBURGH & SCOTT LS 1300 PARALLEL GEAR REDUCER / SPEED REDUCER / GEARBOX

MANUFACTURER: HORSBURGH AND SCOTT
 MODEL NO.: LS-1300
 SERIAL NO.: J-4317
 HP RATING: 18.9
 INPUT RPM: 850
 RATIO: 5.5:1
 REDUCTION: SINGLE
 SERVICE FACTOR: 1.0
 TYPE: PARALLEL
 GEAR TYPE: HELICAL
 BEARING TYPE: ROLLER
 WEIGHT: 450 LBS.

(14 KW)

(200 KG)

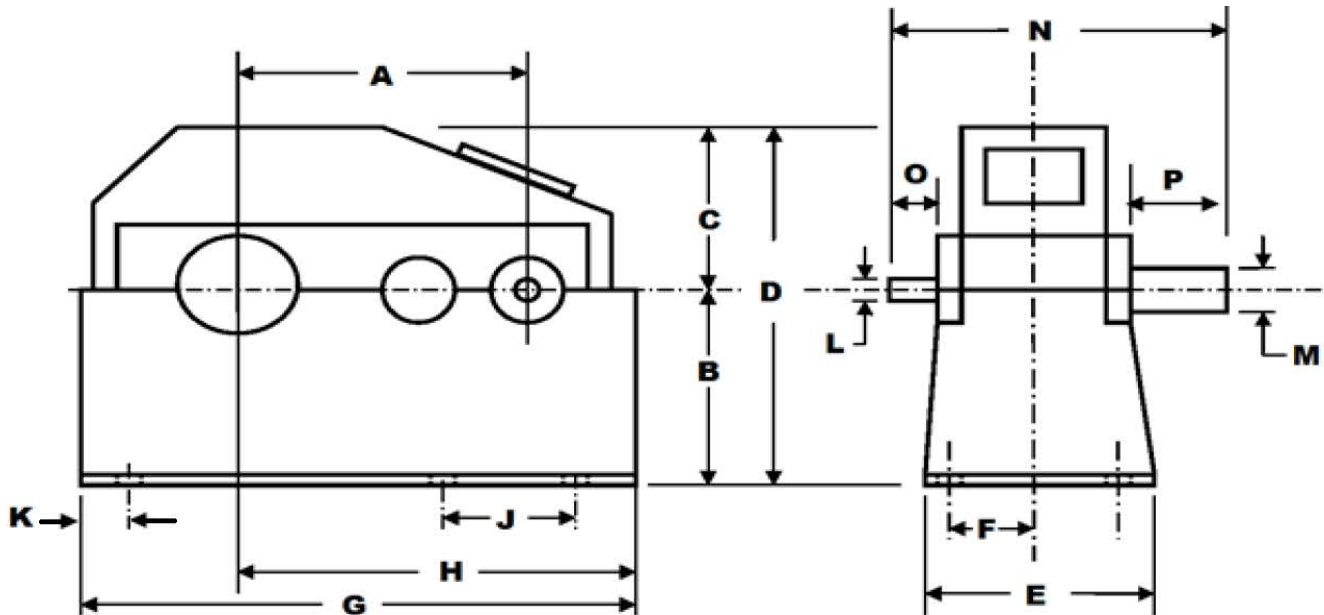

A=6.5"	E=12"		N=20"
B=7.75"	F=4.5"	K=1.625"	O=2.75"
C=7"	G=19.375"	L=1.375"	P=3.75"
D=14.75"	H=11"	M=2.375"	

INVENTORY ID: 106216-000-00 (REFERENCE TAG 106217-000-00 FOR SIMILAR GEARBOX)

CASEYUSA®

Revised 1/24/18

Page 1 of 1

CASEY

275 Kappa Drive, Pittsburgh, PA 15238

Ph: (800) 882-7000 • (412) 963-1111

Fax: (412) 963-0378

E-mail: mechanicalsales@caseyusa.com

Web: www.caseyusa.com